

环保物料

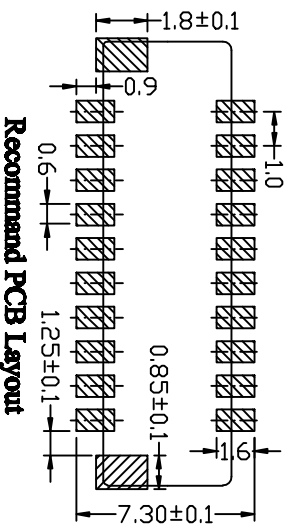
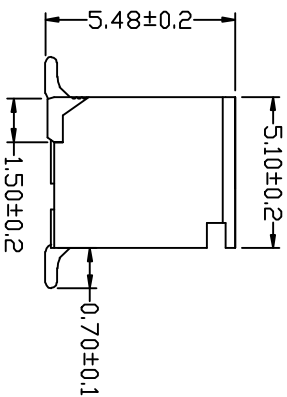
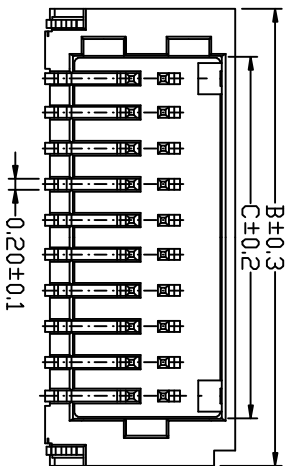
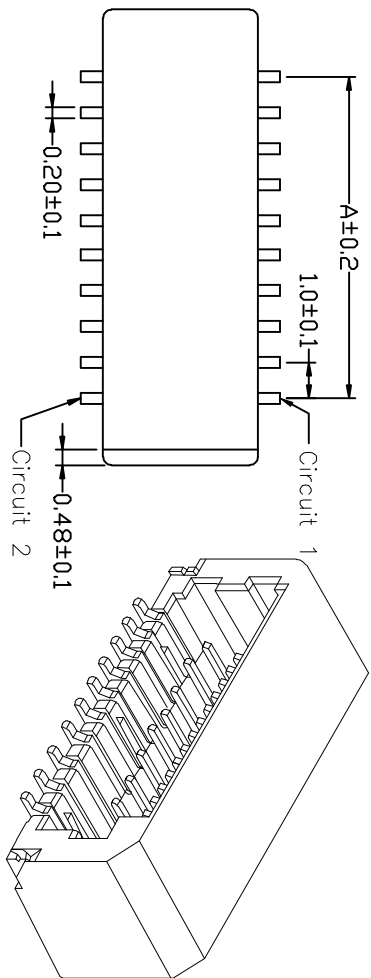

Poles	Part No	Dimensions (mm)		
		A	B	C
20	J1002WR-2*10P	9.00	13.10	10.50
30	J1002WR-2*15P	14.00	18.10	15.50
40	J1002WR-2*20P	19.00	23.10	20.50
50	J1002WR-2*25P	24.00	28.10	25.50

- Specifications(规格):
- Voltage rating(额定电压): 50V AC/DC
 - Current rating(额定电流): 1A AC/DC
 - Withstanding voltage(耐压值): 500V AC/minute
 - Temperature range(工作温度): -25°C~+85°C
 - Insulation resistance(绝缘电阻) ≥100MΩ
 - Contact resistance(接触电阻): ≤20mΩ
 - After environmental testing(环境测试后): ≤30mΩ

- Wafer(针座)
- Part No. (料号): J1002WR-2*XX
 - Poles (PIN数): 20、30、40、50
 - Material (材质): Nylon 9T (尼龙9T) UL 94V-0
 - Pin针: Phosphor Bronze (磷青铜)
 - Finish (电镀): Tin-Plated (镀锡)
 - Solder Tabs: Phosphor Bronze (磷青铜)
 - Finish (电镀): Tin-Plated (镀锡)
 - Mates With HLB 1002H00 Series Dual Row Wafer (匹配1002双排系列胶壳)
 - Q'ty (数量): 1,000Pcs/Bag/每袋 (1,000Pcs)

东莞市翰皓精密电子有限公司

Dongguan HanHao Precision Electronics Co., Ltd

料号 PART NO J1002WR-2*XX

批准 APPD 审核 CHK 绘图 DR 日期 DATA

品名 TITLE 1.00 mm Crimp Style connectors

一般公差
GENERAL TOLERANCE
.I ±0.3
.II ±0.2
.III ±0.1

角法 PROJECT

批准 APPD 审核 CHK SUCCESS

绘图 DR 刘艳

日期 DATA 2007/05/03

单位 UNIT MM

比例 SCALE 1/1

图号 NUMBER A-106 版本 REV B

2011/05/14	A	B	修改图框格式	审核 CHK	批准 APPD
日期 DATE	旧版本 OLD REV	新版本 NEW REV	变更内容 DESCRIPTION		

1	2	3	4	5	6	7	8
---	---	---	---	---	---	---	---

1	2	3	4	5	6	7	8
---	---	---	---	---	---	---	---

1	2	3	4	5	6	7	8
---	---	---	---	---	---	---	---

1	2	3	4	5	6	7	8
---	---	---	---	---	---	---	---

1	2	3	4	5	6	7	8
---	---	---	---	---	---	---	---

1	2	3	4	5	6	7	8
---	---	---	---	---	---	---	---

1	2	3	4	5	6	7	8
---	---	---	---	---	---	---	---

1	2	3	4	5	6	7	8
---	---	---	---	---	---	---	---

1	2	3	4	5	6	7	8
---	---	---	---	---	---	---	---

1	2	3	4	5	6	7	8
---	---	---	---	---	---	---	---

1	2	3	4	5	6	7	8
---	---	---	---	---	---	---	---

1	2	3	4	5	6	7	8
---	---	---	---	---	---	---	---

1	2	3	4	5	6	7	8
---	---	---	---	---	---	---	---

1	2	3	4	5	6	7	8
---	---	---	---	---	---	---	---

1	2	3	4	5	6	7	8
---	---	---	---	---	---	---	---